



A POLYTECHNIC INSTITUTION

British Columbia Institute of Technology Burnaby Campus



BCIT's Burnaby campus is the largest of our five locations. Beautiful greenspace lines the south end of the grounds, which feature Guichon Creek and a one-kilometre nature trail. The facilities listed in this brochure are just the beginning of what this campus has to offer. Conveniently located beside the Trans Canada Highway, with ample parking for \$3 per day, hotel accommodation nearby and two major shopping centres within minutes, BCIT can host your next meeting, trade show, conference or special event with distinction.

The place to meet on Canada's West Coast

BUILDING SE-2

BCIT Burnaby Campus

Building South East 2 (SE-2)

The heart of BCIT's Burnaby campus, this building features the Great Hall, a naturally-lit, courtyard-style lounge with a vaulted ceiling three stories above. Four adjacent Town Square conference rooms offer an array of sizes and set-up options to meet your requirements. The building is also home to three dining facilities – the Rix Club eatery, Professor Mugs Pub, and large 'food-court' style cafeteria operated by Chartwell's Catering.



Great Hall



Town Square D

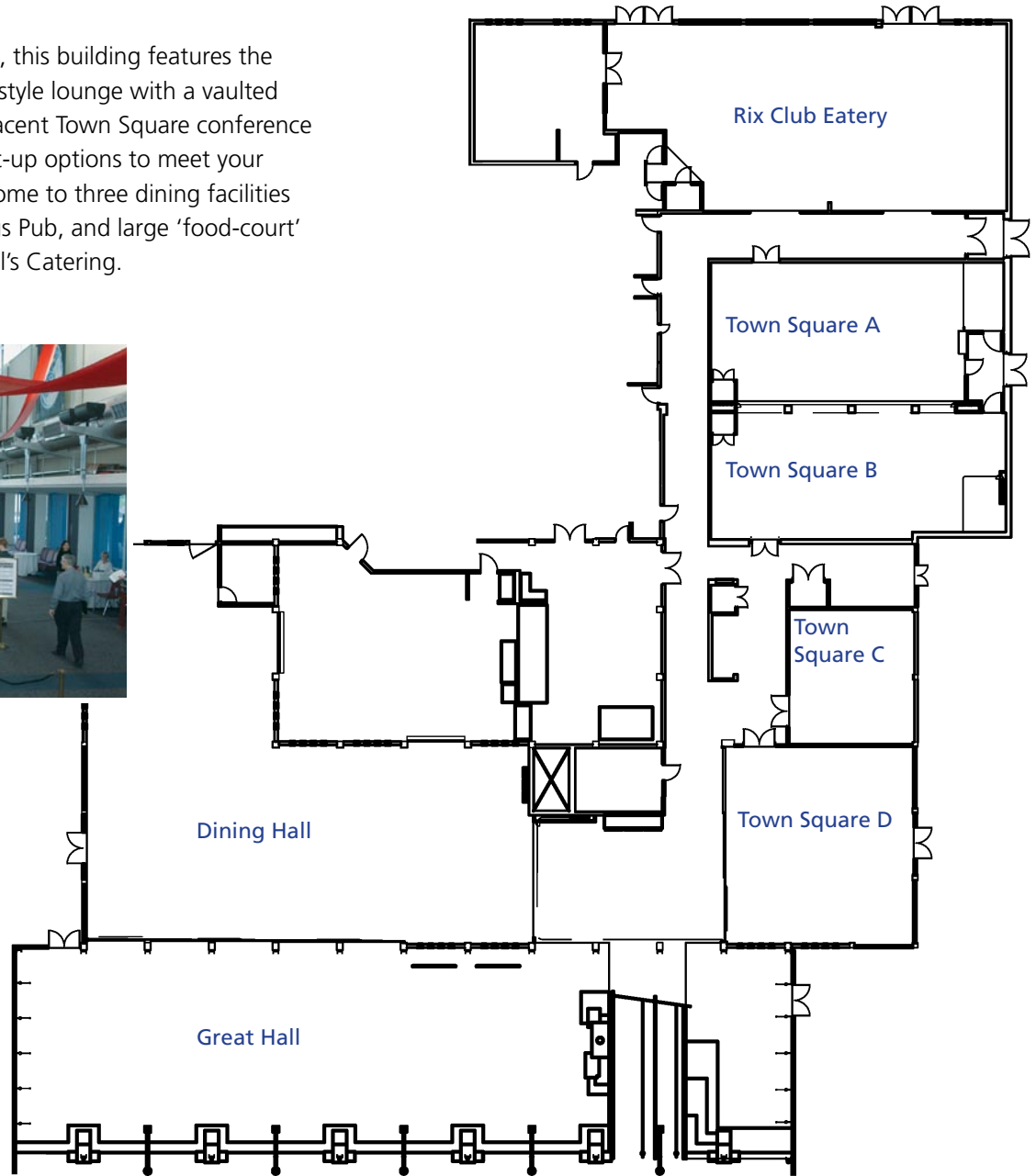

Meeting Room Rental Rates

Description	Room Number	Square Footage	Theatre Style	Classroom Style	U-Shape	Hollow Square	Boardroom Style	Reception	Banquet	Dinner Dance	Exhibits	Price Per Day
Town Square Conference Rooms												
Town Square A (SE-2)	212A	1,480	135	75	55	60	50	145	72			\$280
Town Square B (SE-2)	212B	1,370	125	75	50	55	45	135	64			\$260
Town Square A&B (SE-2)	212	2,900	250	125				280	140	180		\$450
Town Square C (SE-2)	213	600	50	35	25	28	25	55	40			\$150
Town Square D (SE-2)	214	1,440	130	70	35	36	35	140	55	75		\$220
Great Hall (SE-2)		4,530	300					500				Subject to availability – rates are seasonal

*Prices in effect as of September 2006

BUILDING SE-6

BCIT Burnaby Campus

Building South East 6 (SE-6) IBM Techology Building

The lobby of SE-6 features an arched bridge and sky lights connecting the hall of naturally-lit classrooms to the main entrance. Newly renovated, the Telus Theatre's tiered seating accommodates up to 300 in comfort and style, with all the amenities required for your lecture-style event: sound system, lighting and a ceiling-mounted LCD Projector. Ten adjoining classrooms (not shown) are available for smaller meetings and breakout sessions. All classrooms are equipped with whiteboards and overhead projectors. The lobby connects to SE-2, mere steps to the Rix Club eatery, Town Square Rooms and Great Hall.

Meeting Room Rental Rates

Description	Room Number	Classroom Style	Price Per Day
Telus Theatre (SE-6)	233	300	\$450
Other theatres (not on floorplans)			
NE-1	331	130	\$250
SE-1	109	137	\$250
SW-1	1015, 1021, 1025	90-99	\$210
SW-1	1205	233	\$320
SW-3	1710, 1750	110	\$220
SW-5	1840	179	\$320
SW-5	1850	179	\$290
SW-5	1840/1850	358	\$450
Small Classroom	All buildings	0-25	\$120
Large Classroom	All buildings	25+	\$160

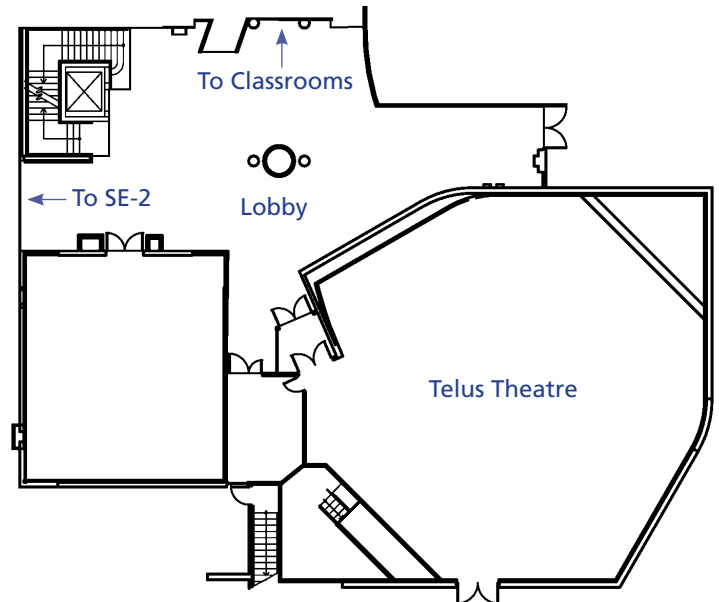

BUILDING SE-16

BCIT Burnaby Campus

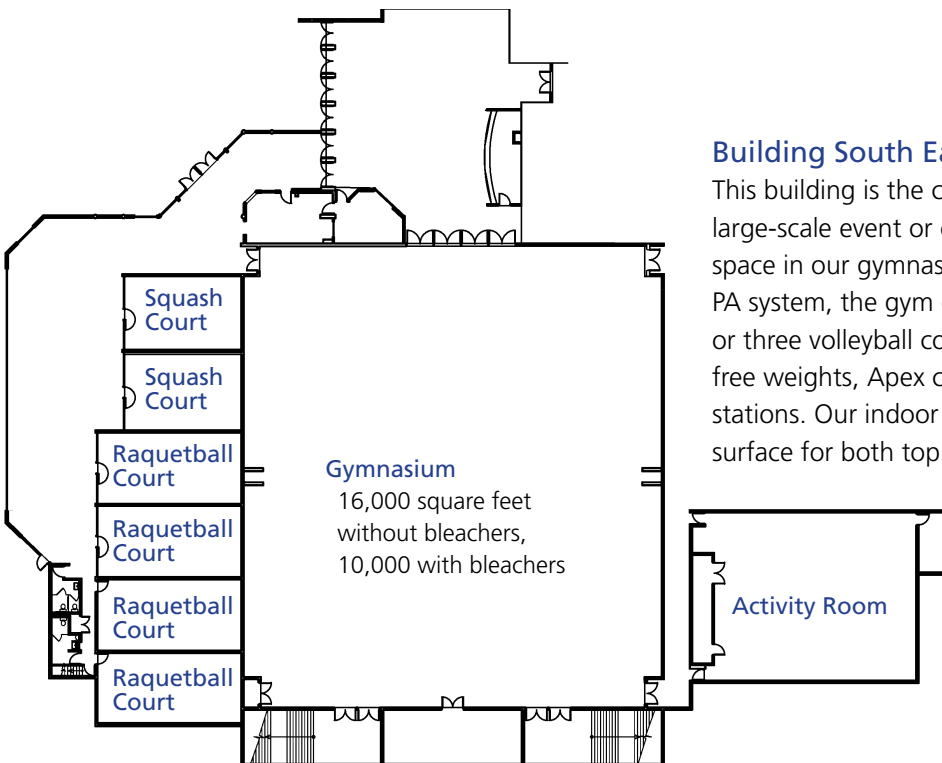

Building South East 16 (SE-16)

This building is the campus recreation centre. Your next tradeshow, large-scale event or corporate teambuilding day will have ample space in our gymnasium. Equipped with a built-in, state-of-the-art PA system, the gym can accommodate eight badminton, two basketball or three volleyball courts. The Fit Pit fitness centre is equipped with free weights, Apex circuit machines and more than 25 new cardio stations. Our indoor climbing wall features 800 square feet of climbing surface for both top rope and bouldering. The building also houses two squash courts, three racquetball courts, games room, activity room, lounge area, shower facilities, and locker rooms. Outdoor facilities include: sports field, track, tennis courts and more.

Meeting Room Rental Rates

Description	Square Footage	Theatre Style	Classroom Style	Reception	Exhibits	Price Per Day
Gymnasium (SE-16)	16,000	1,000 +	600	1,000 +	82	\$135 per hour (4 HR MIN)

BUILDING SE-40

BCIT Burnaby Campus

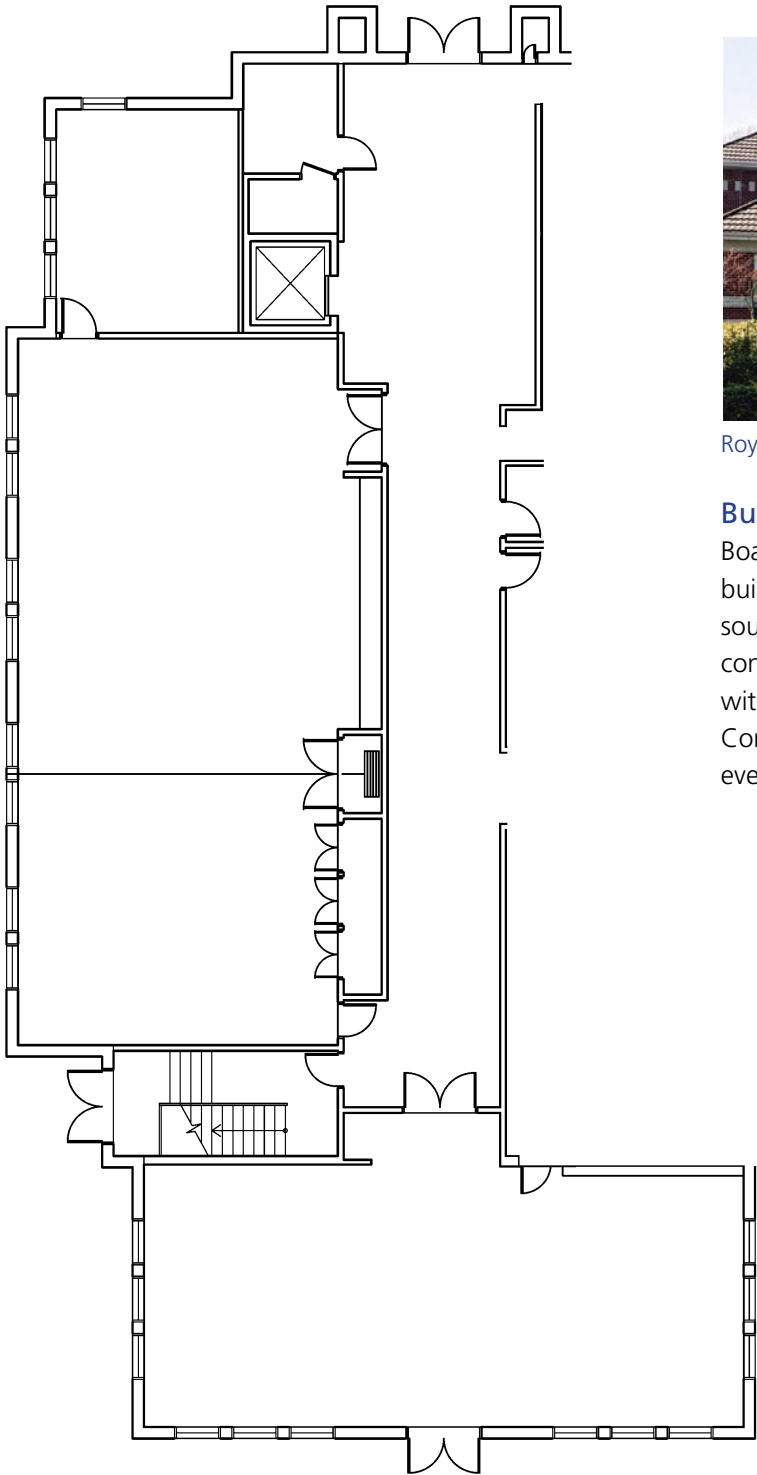

Royal Oak Building (SE-40)

Building South East 40 (SE-40)

Boasting a beautiful brick colonial-style exterior, this elegant building is set apart from the main campus, located in the far southeast corner of the grounds. BCIT's Board of Governors convene in the Royal Oak Boardroom, a luxurious meeting space with a cherrywood boardroom table and ergonomic chairs. Complete with a gallery and dining area, this building has everything you need to host your event in style.



Royal Oak Boardroom

For more information or to book your event, please contact us at:

Telephone: 604.431.4997

E-mail: meetings@bcit.ca

Web: bcit.ca/meetings

Prices in effect as of September 2006

Meeting Room Rental Rates

Description	Room Number	Square Footage	Theatre Style	Classroom Style	U-Shape	Price Per Day
Royal Oak Boardroom (SE-40)	120	1,172			25	\$350
Royal Oak Gallery (SE-40)	140	660	30	18		\$150